



**Thorntons**   
The right way to move

## Woodbine House 11-13 King Street

Newport-on-Tay, Fife  
DD6 8BN





## Summary

Just 15 minutes from central Dundee, this handsome semi-detached period end villa occupies a large plot with mature well-stocked gardens, numerous outbuildings (including a summer house and workshop) and a gated driveway with a twin carport and further parking space. The distinctive and spacious interiors create a comfortable family home with two reception rooms, dining kitchen, utility room, shower room, an additional WC, and four double bedrooms, including an impressive principal suite with a bathroom, dressing room, and home office. The two main bedrooms overlooking the gardens also boast wonderful river views; the walled gardens consist of the front garden and a large side garden. Capturing all-day sun, the plots offer potential for a variety of purposes including a space for creative working, a market garden, pets or chickens.

## Features

- Charming, period, semi-detached end villa
- Porch and wood panelled reception hall
- Living / dining room with log burner
- Sitting room
- Dining kitchen with street door access and a utility room
- Principal suite including four-piece bathroom, dressing room, and office/5<sup>th</sup> bedroom
- Three further double bedrooms
- First-floor shower room, ground-floor WC
- Large, gated driveway with carport
- West, river-facing garden with summer house
- Gas central heating
- Double glazing throughout
- Floored attic for extra storage
- 14 solar panels
- Option to buy plot with outline planning permission (separate to sale of house and gardens)



“ The bedrooms include an impressive principal suite complete with dressing room, four-piece bathroom and office.”







“The large enclosed plot features a river-facing garden with a summer house, gated private parking, and a plot with development potential.”



# Floorplan

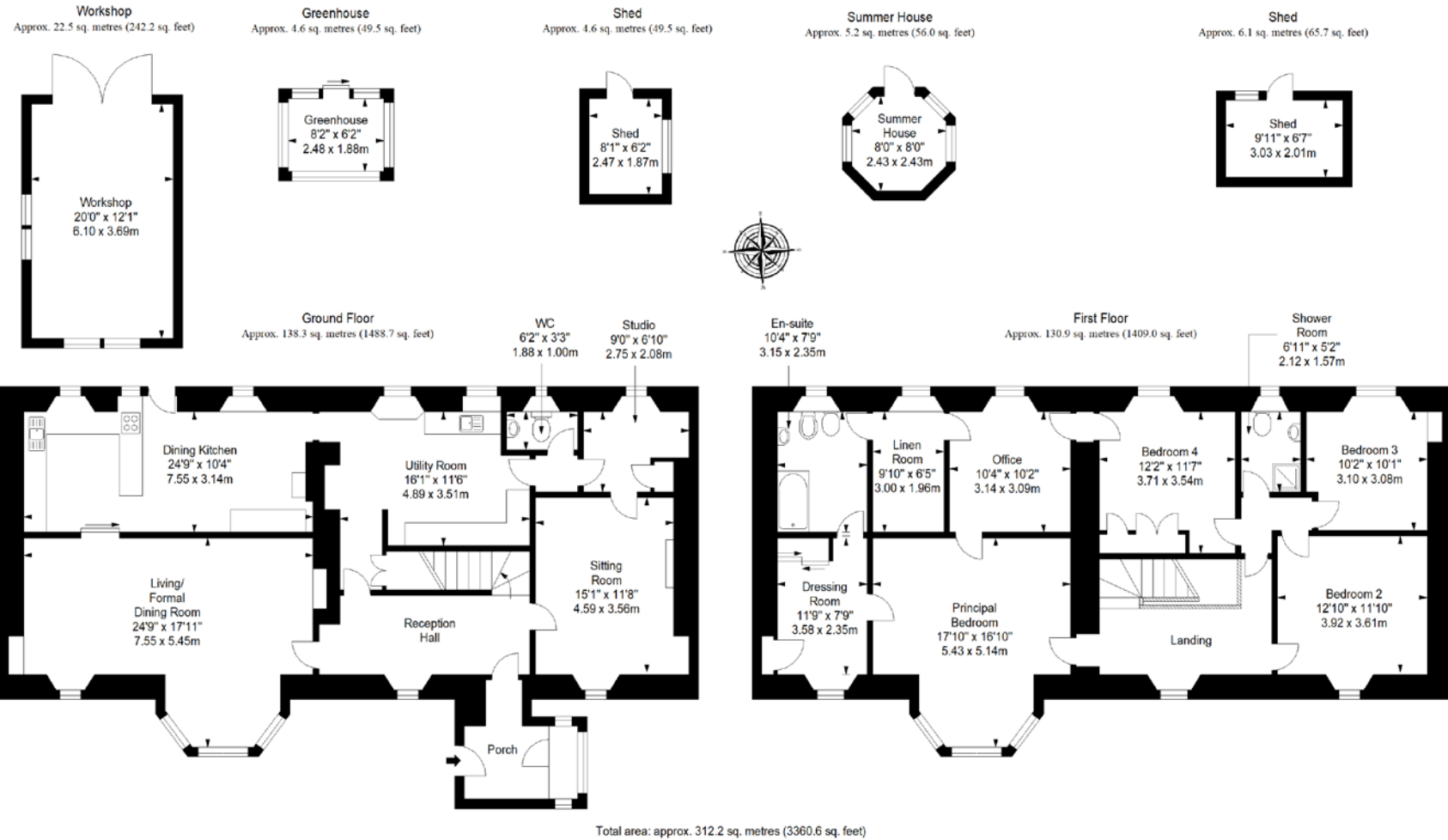

Extras: All fitted floor and window coverings, and light fittings are included, in addition to a new shed housing garden furniture, potting shed, woodshed, workshop with tools, bench with vice, a small greenhouse, and a sitooterie swing seat.



# Thorntons

The right way to move

## Our Branches

### ANSTRUTHER

5A Shore Street, Anstruther, KY10 3EA  
01333 310481  
anstrutheea@thorntons-law.co.uk

### BONNYRIGG

3-7 High Street, Bonnyrigg, EH19 2DA  
0131 663 7135  
bonnyriggea@thorntons-law.co.uk

### DUNDEE

Whitehall House, 33 Yeaman Shore  
Dundee DD1 4BJ  
01382 200099  
dundeeya@thorntons-law.co.uk

### FORFAR

53 East High Street, Forfar, DD8 2EL  
01307 466886  
forfarea@thorntons-law.co.uk

### PERTH

7 Whitefriars Crescent, Perth, PH2 0PA  
01738 443456  
perthea@thorntons-law.co.uk

### ARBROATH

165 High Street, Arbroath, DD1 1DR  
01241 876633  
arbroathea@thorntons-law.co.uk

### CUPAR

49 Bonnygate, Cupar, KY15 4BY  
01334 656564  
cupareaa@thorntons-law.co.uk

### EDINBURGH

Citypoint, 3rd Floor, 65 Haymarket  
Terrace, Edinburgh, EH12 5HD  
0131 297 5980  
edinburgea@thorntons-law.co.uk

### MONTROSE

55 High Street, Montrose, DD10 8LR  
01674 673444  
montroseea@thorntons-law.co.uk

### ST ANDREWS

17-21 Bell Street, St Andrews, KY16 9UR  
01334 474200  
standrewsea@thorntons-law.co.uk



@ThorntonsPropertyServices



@thorntonsproperty



@ThorntonsPS

Thorntons is a trading name of Thorntons Law LLP  
Regulated by The Law Society of Scotland