

Offers Over £260,000

Blackadders



blackadders.co.uk

2 Scotswood Terrace,
Dundee, DD2 1PA



- Ground Floor Apartment
- Sought After Location
- Living Room

- Dining Room
- Kitchen
- 2 Double Bedrooms

- Bathroom
- Private Terraced Gardens



2



1



2



E



D



This is a most attractive and deceptively spacious ground floor apartment affording adaptable and comfortable accommodation on one level. The property forms part of an imposing detached Victorian Villa (circa 1890) lying to the West of the city. It is well located for easy communications into Perth Road, Dundee University and Ninewells Hospital, and forms part of a sought after cul de sac of similar properties.



The subjects retain many wonderful period features including ornate corbels, centre pieces, fireplaces and cornice work. The accommodation extends to approx. (119sqm) and comprises entrance vestibule, impressive reception hallway, wonderful lounge, two double bedrooms, spacious bathroom, dining room and well-equipped fitted kitchen. The lounge is a particular feature with bay window to the front with wonderful period marble fireplace, fine ornate cornice work and centre pieces. Both bedrooms are double in size and the dining room provides ample room for table and chairs. The kitchen includes electric hob, oven and extractor and all white goods are included. The bathroom has a three-piece suite with instant shower, extensive tiling and there is a heated towel rail. Gas fired central heating is installed.

Externally and to the front of the property there is an attractive area of mature terraced garden with upper east most patio and terrace. To the side of the property there is an easily managed area leading to the rear courtyard which provides access onto Blackness Road. Useful traditional outbuildings. It should be noted also that there is a sizeable cellar area providing excellent additional storage.

This is an impressive and fine traditional home making viewing essential.



Accommodation (measurements are approx)

Living Room	4.84m x 6.49m	(15'11" x 21'4")
Dining Room	4.20m x 4.24m	(13'9" x 13'11")
Kitchen	2.16m x 2.38m	(7'1" x 7'10")
Bedroom 1	4.75m x 4.76m	(15'7" x 15'7")
Bedroom 2	3.73m x 4.24m	(12'3" x 13'11")
Bathroom	1.60m x 3.40m	(5'3" x 11'2")

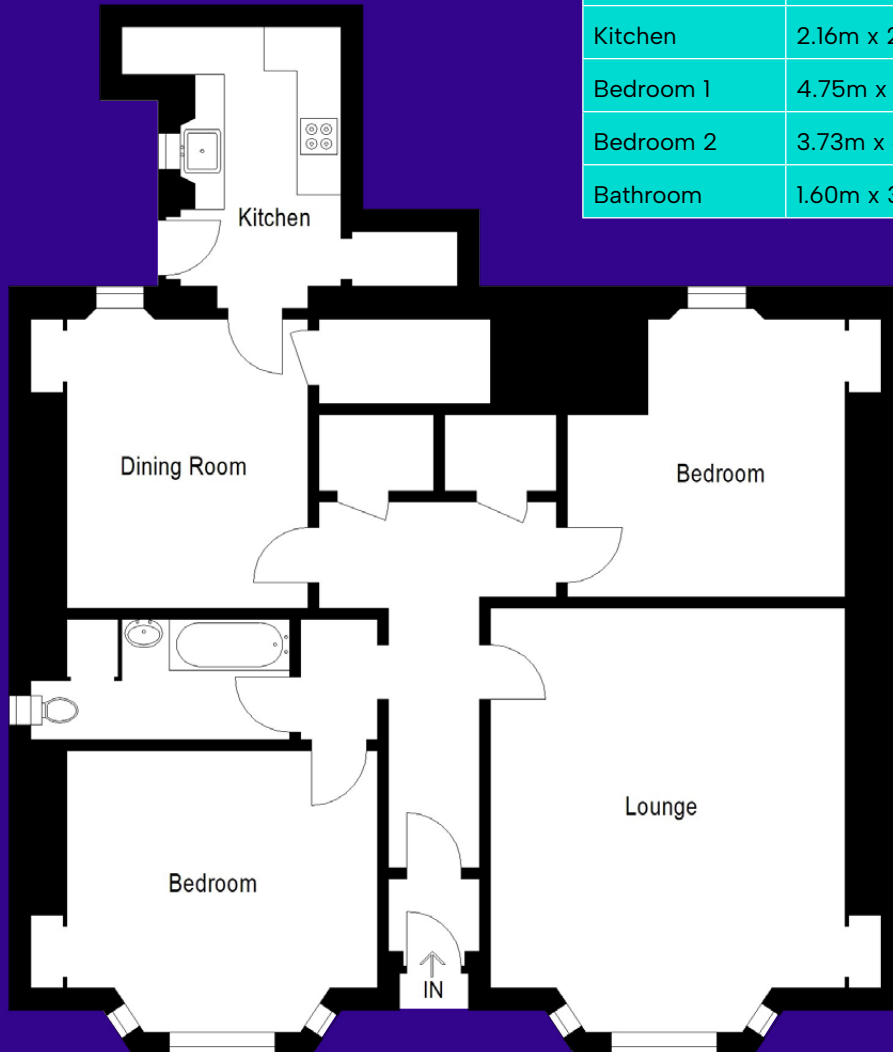



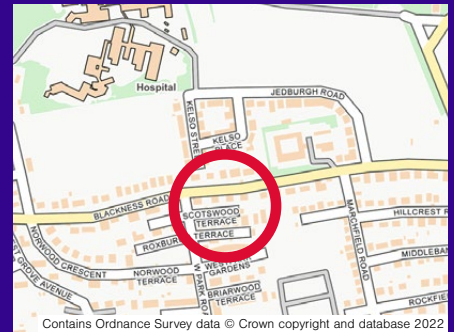

Aberdeen

37 Langstane Place
Aberdeen
AB11 6EN

Tel: 01224 452750

Dundee

30 & 34 Reform Street
Dundee
DD1 1RJ

Tel: 01382 342222

DISCLAIMER. Entry by mutual arrangement. Viewing strictly through selling agents. Whilst we endeavour to make these particulars as accurate as possible, they do not form any part of any contract or offer nor are they guaranteed. Measurements are approximate and in most cases are taken with a digital tape. If there is any part of these particulars that you find misleading or simply wish clarification on, please contact our office for assistance.

property@blackadders.co.uk